

CHESAPEAKE HALL

FIRST FLOOR

#DukesLiveClose
#DukesLiveSupported
#DukesLIVEON

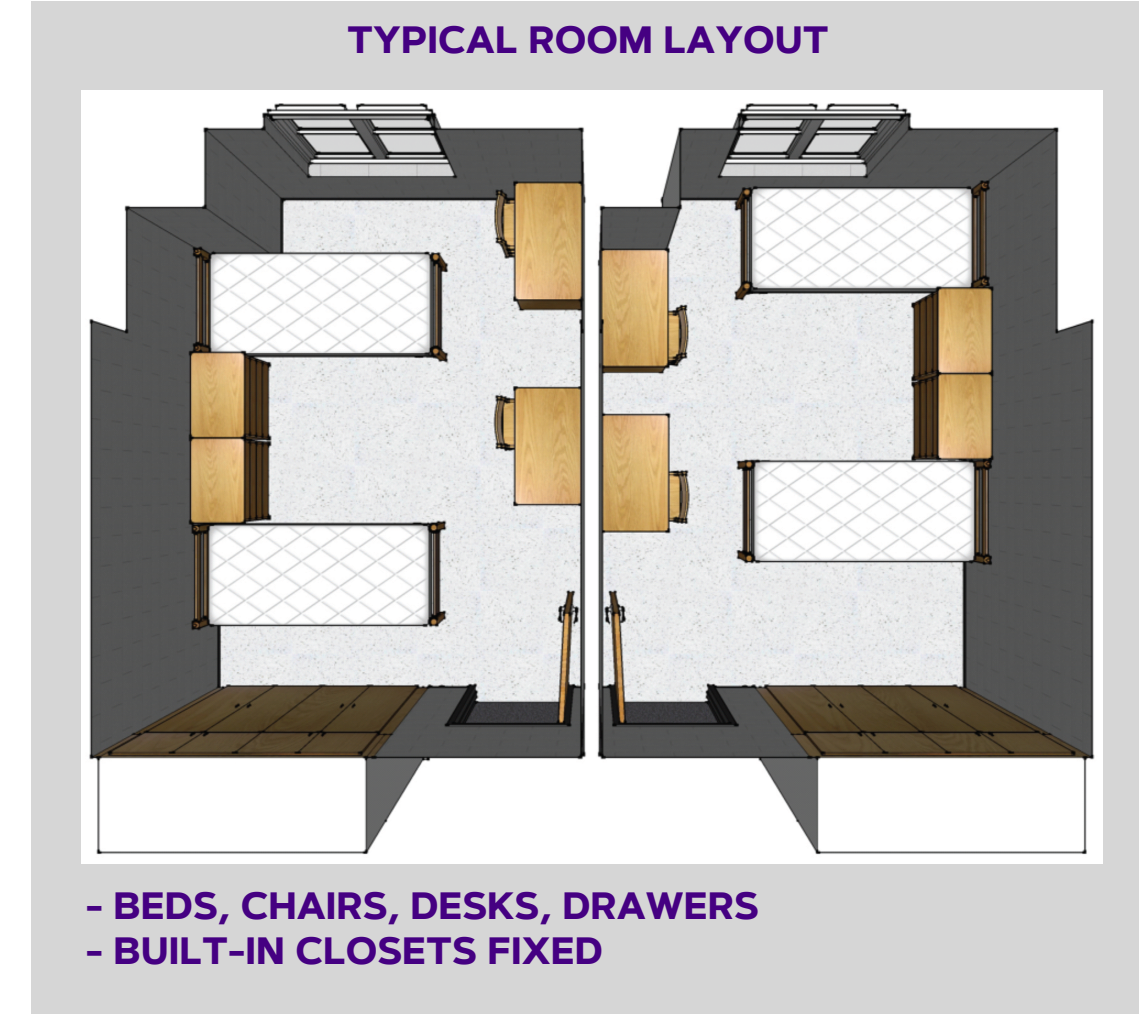
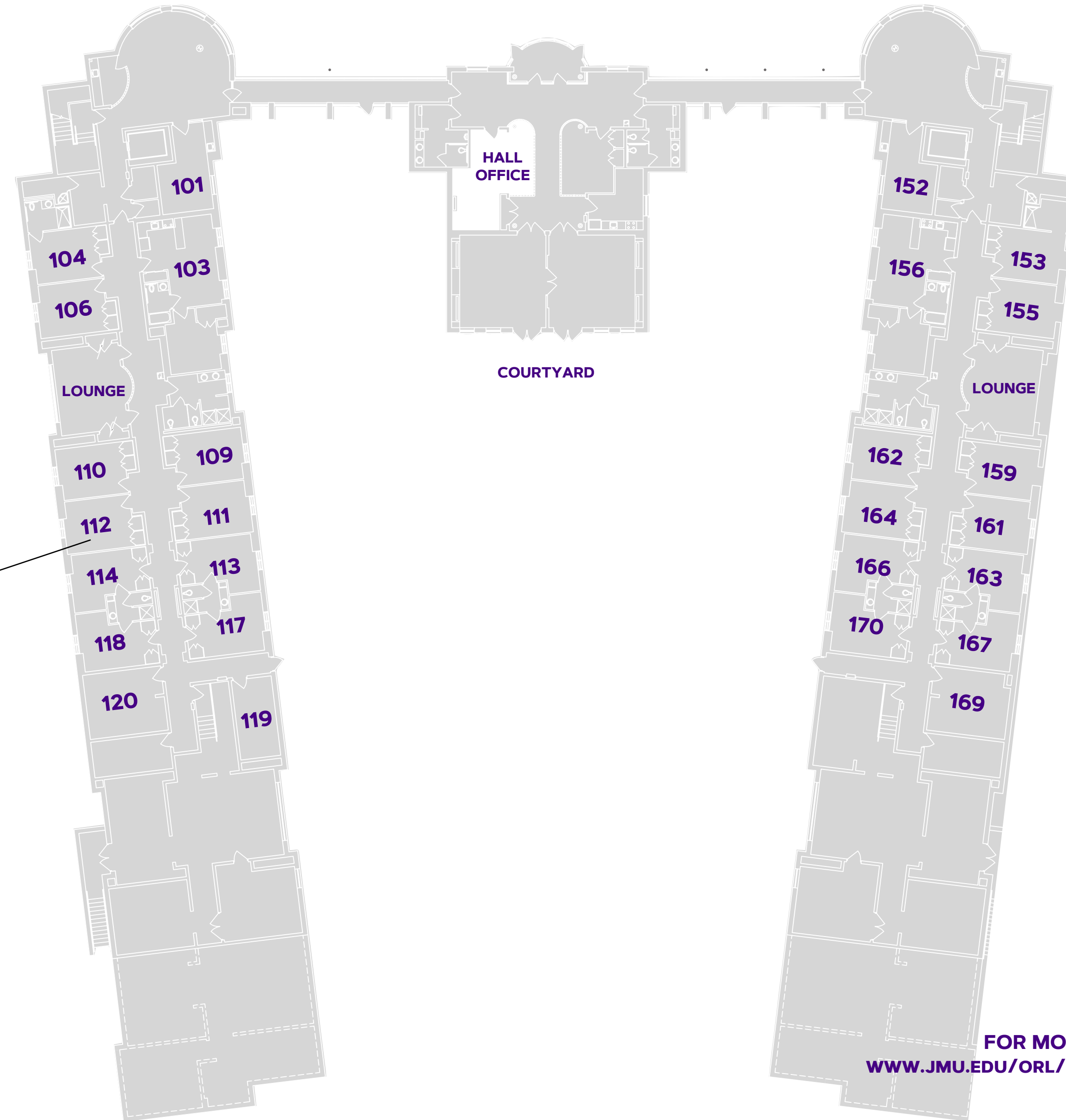

FACES
SHENANDOAH HALL

FACES
CHANDLER HALL

TYPICAL ROOM SPECS

ROOM SIZE: 11'7" x 12'
WINDOW SIZE: 4'4" x 4'8"
CEILING HEIGHT: 9'3"

FOR MORE INFORMATION ON HALLS VISIT:
WWW.JMU.EDU/ORL/OUR-RESIDENCE-HALLS/INDEX.SHTML

CHESAPEAKE HALL

SECOND FLOOR

#DukesLiveClose
#DukesLiveSupported
#DukesLIVEON

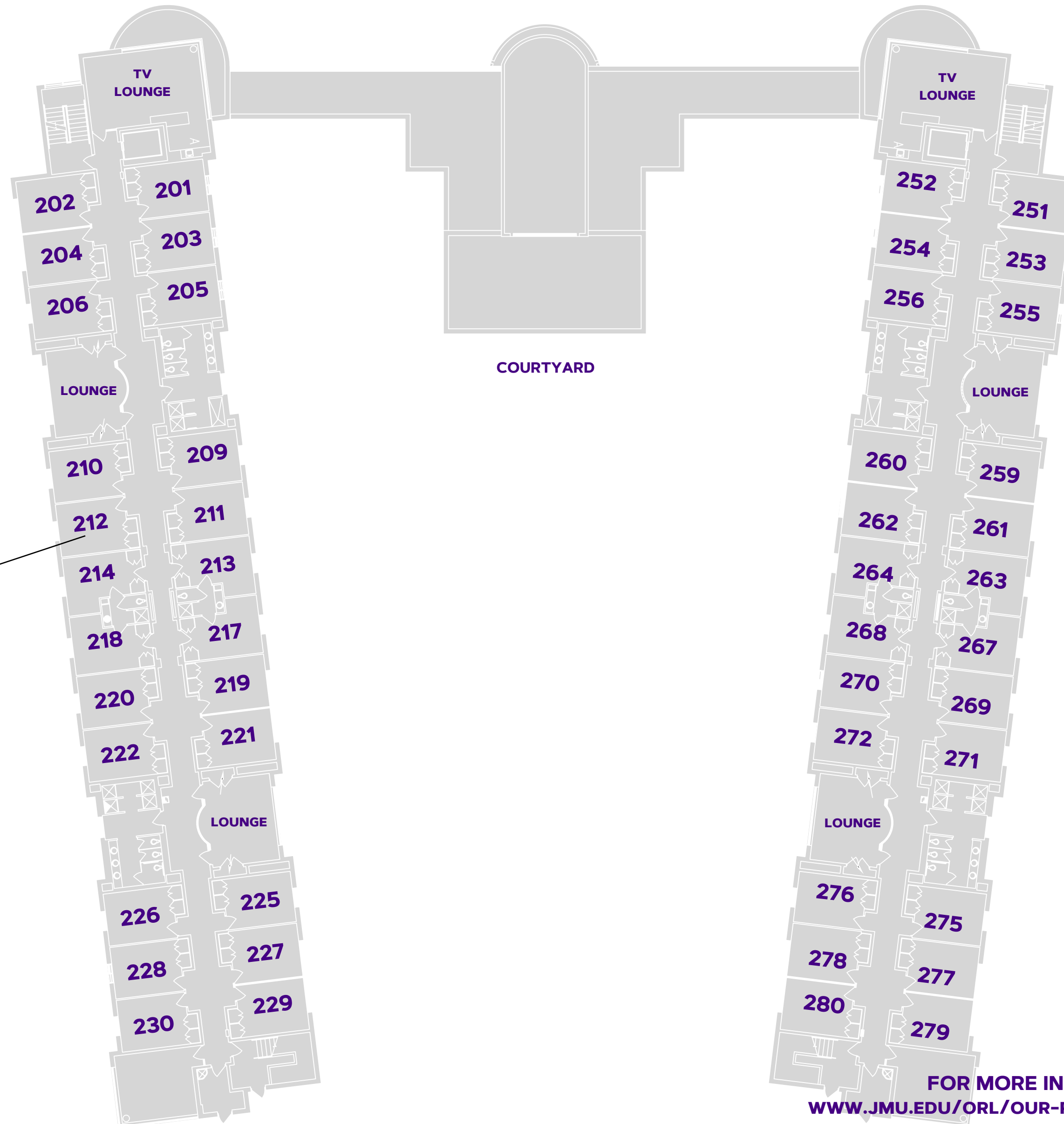

FACES
SHENANDOAH HALL

FACES
CHANDLER HALL

TYPICAL ROOM SPECS

ROOM SIZE: 11'7" X 12'
WINDOW SIZE: 4'4" X 4'8"
CEILING HEIGHT: 9'3"

TYPICAL ROOM LAYOUT

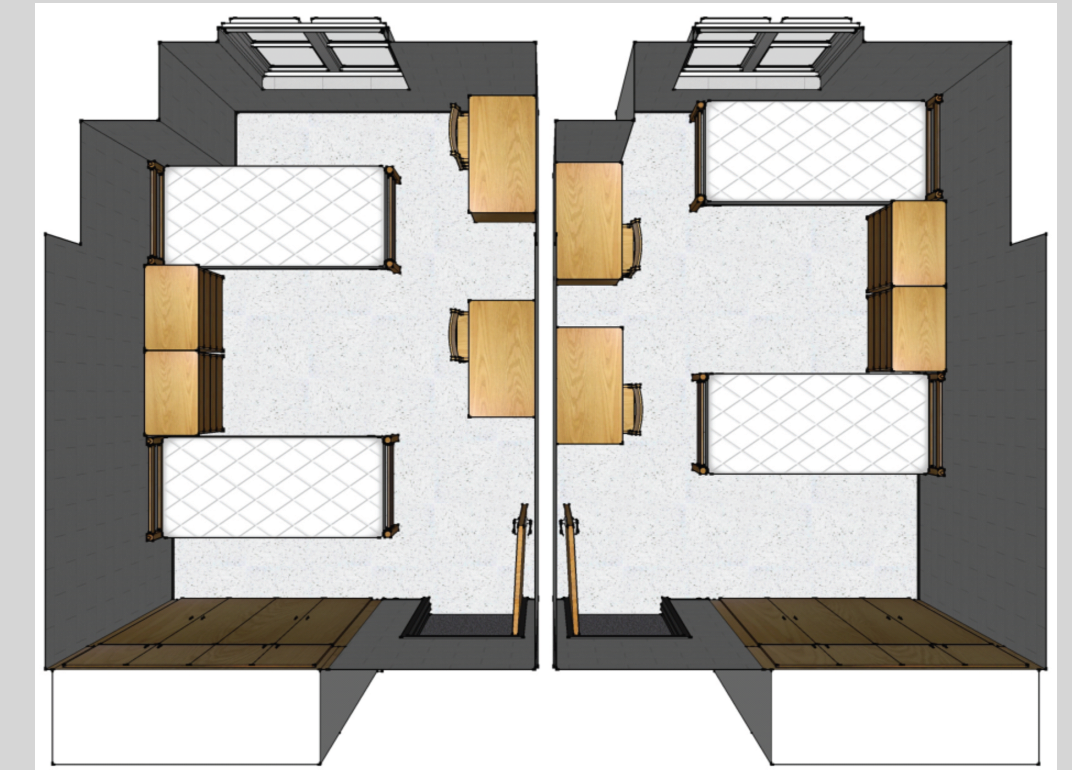

- BEDS, CHAIRS, DESKS, DRAWERS
- BUILT-IN CLOSETS FIXED

FOR MORE INFORMATION ON HALLS VISIT:
WWW.JMU.EDU/ORL/OUR-RESIDENCE-HALLS/INDEX.SHTML



Residence Life

CHESAPEAKE HALL

THIRD FLOOR

#DukesLiveClose
#DukesLiveSupported
#DukesLIVEON

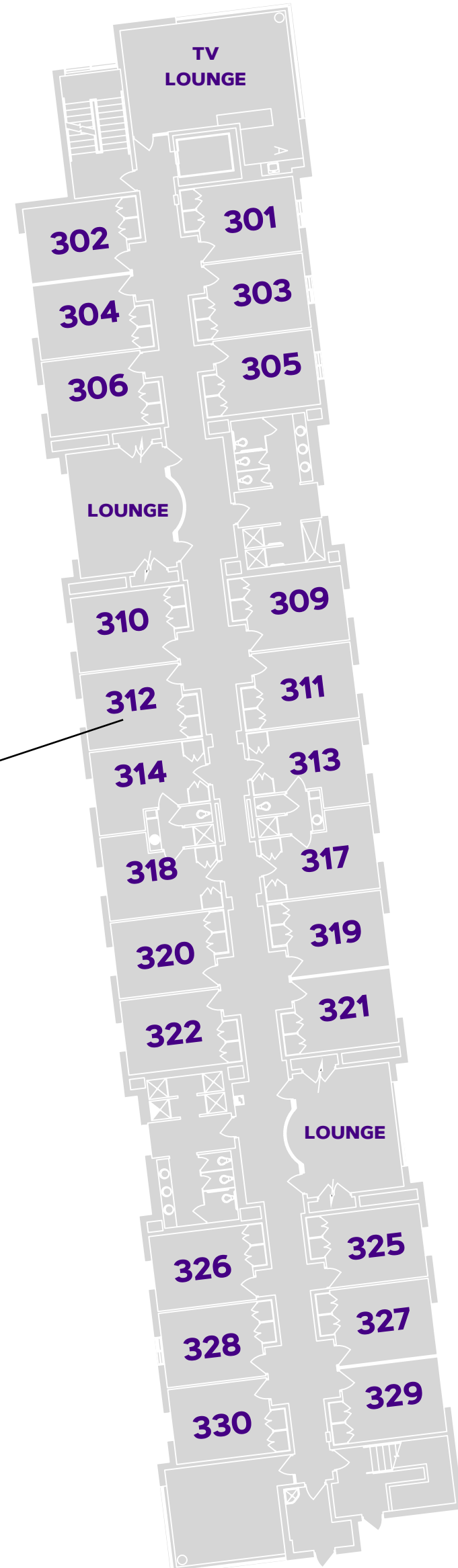

COURTYARD

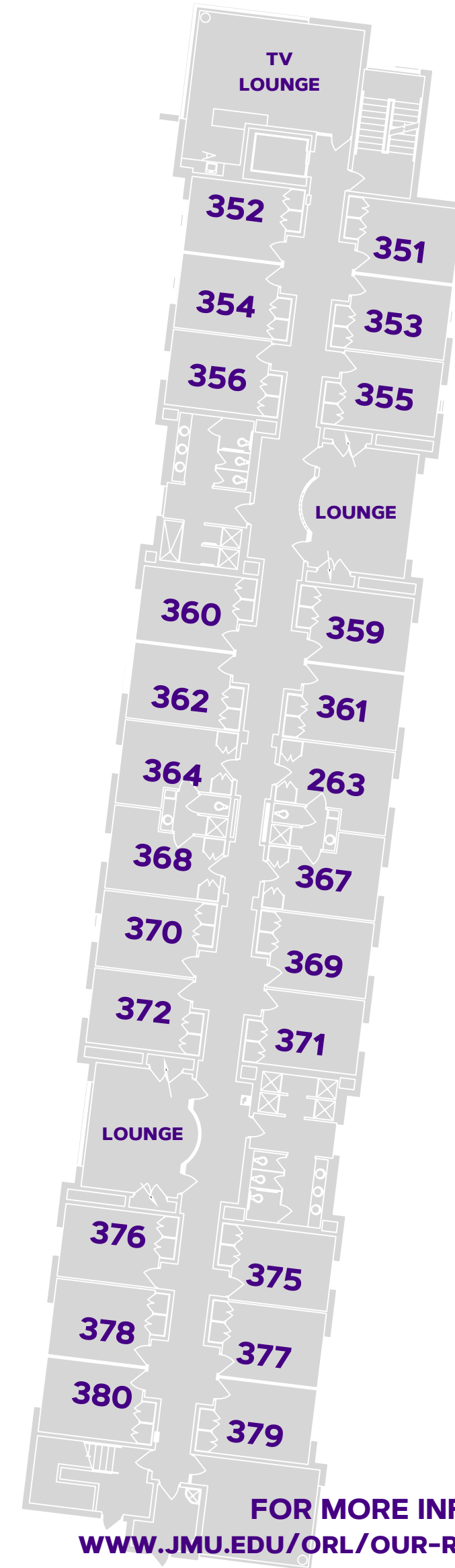

FACES
SHENANDOAH HALL

FACES
CHANDLER HALL

TYPICAL ROOM SPECS

ROOM SIZE: 11'7" X 12'
WINDOW SIZE: 4'4" X 4'8"
CEILING HEIGHT: 9'3"

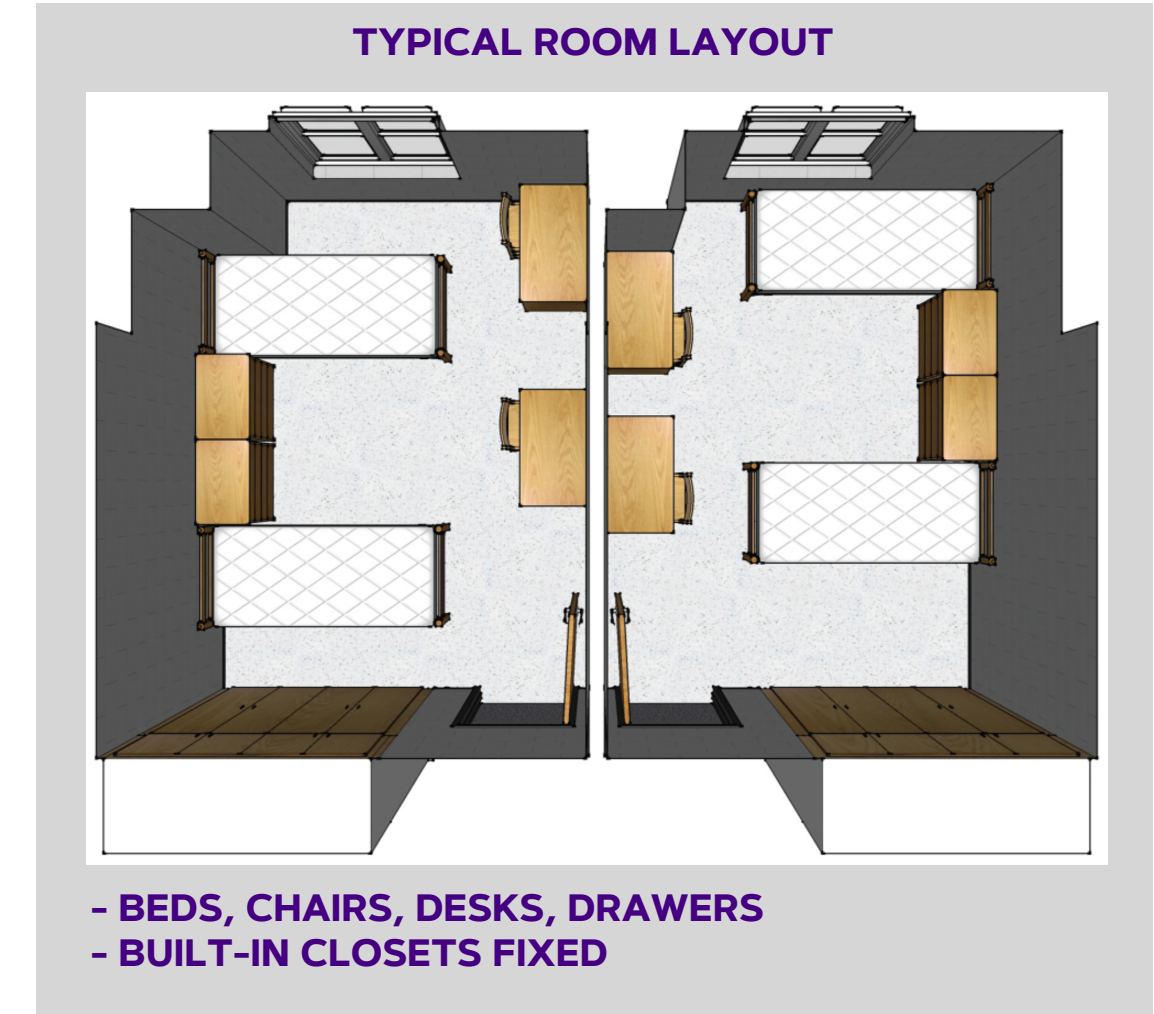

FOR MORE INFORMATION ON HALLS VISIT:
WWW.JMU.EDU/ORL/OUR-RESIDENCE-HALLS/INDEX.SHTML



Residence Life

CHESAPEAKE HALL

FOURTH FLOOR

#DukesLiveClose
#DukesLiveSupported
#DukesLIVEON

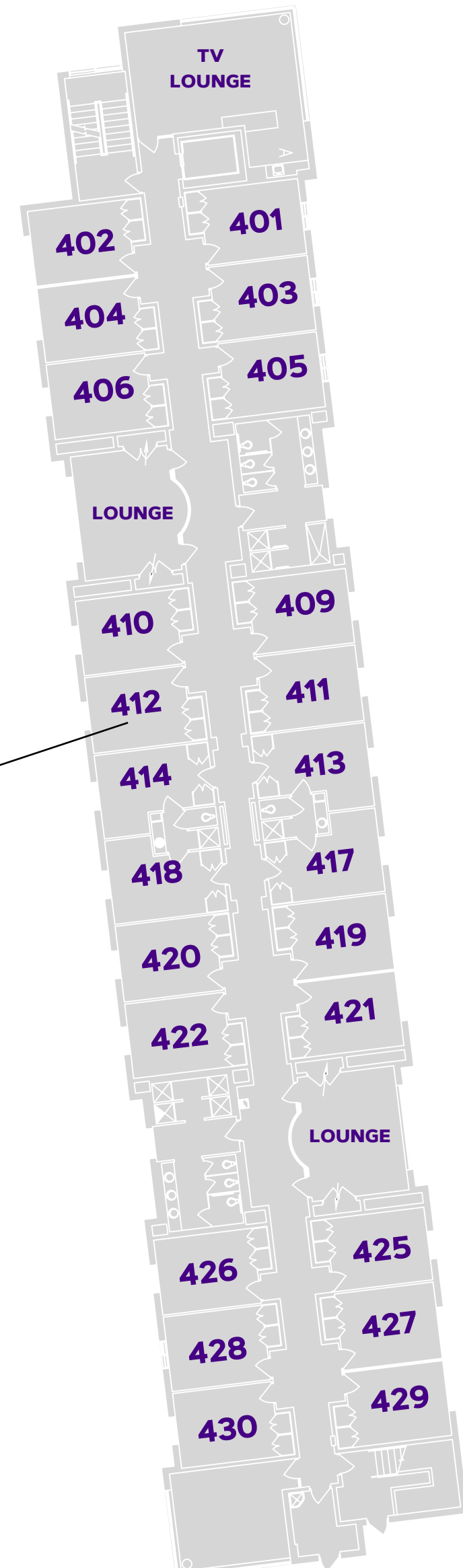

FACES
SHENANDOAH HALL

TYPICAL ROOM SPECS

ROOM SIZE: 11'7" X 12'
WINDOW SIZE: 4'4" X 4'8"
CEILING HEIGHT: 9'3"

COURTYARD

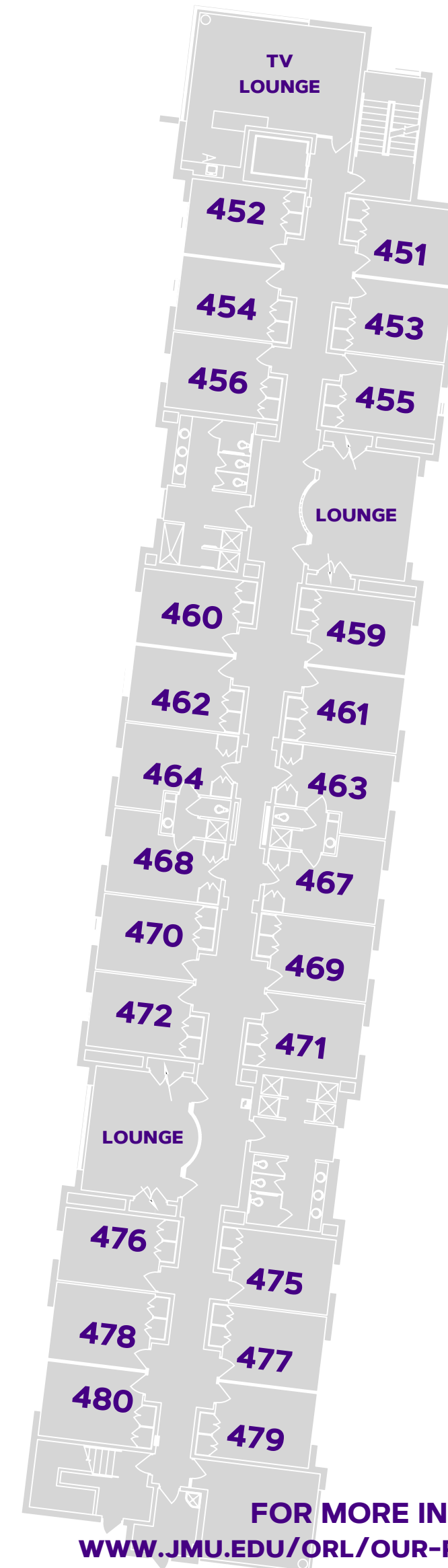

FACES
CHANDLER HALL

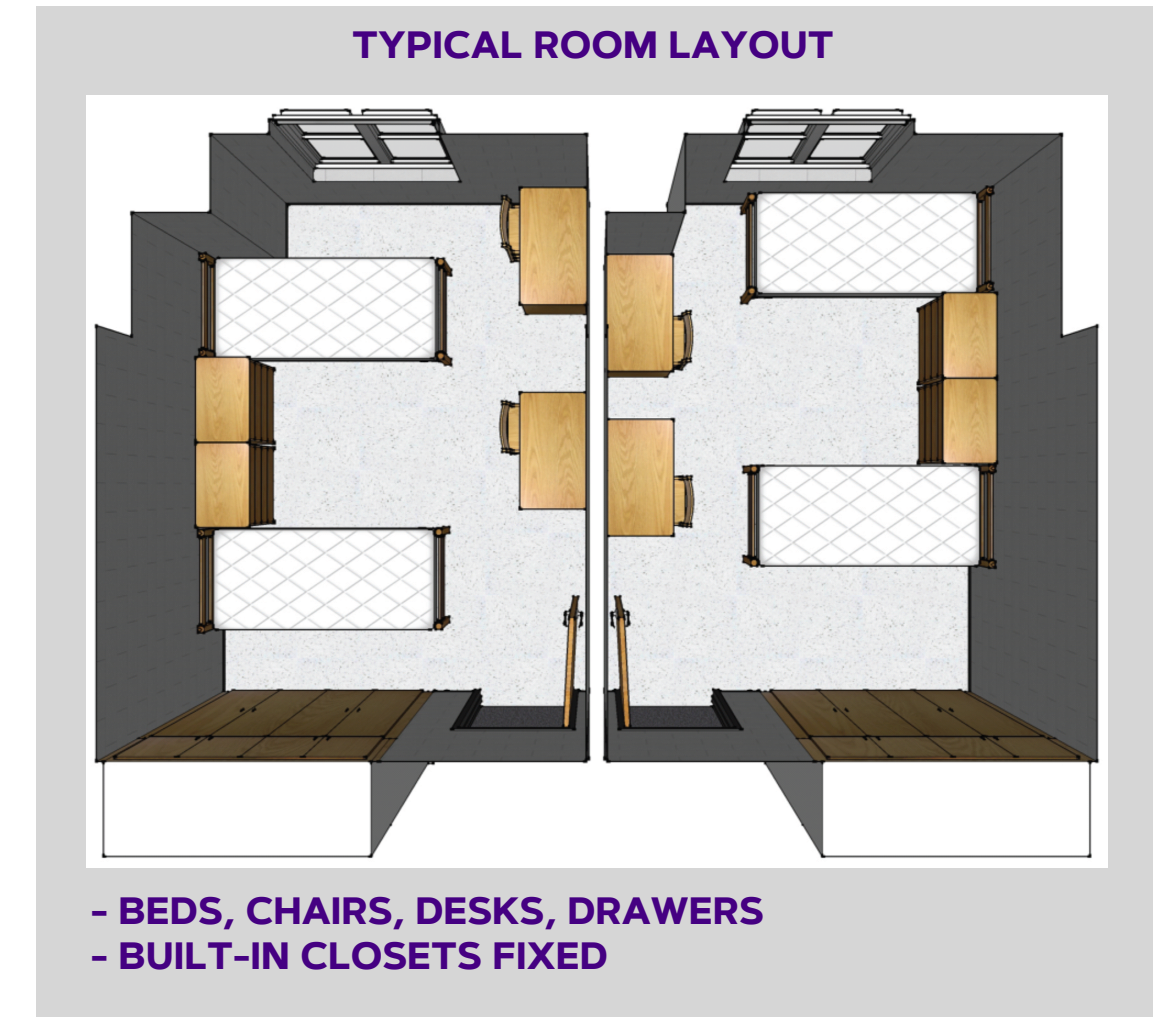

FOR MORE INFORMATION ON HALLS VISIT:
WWW.JMU.EDU/ORL/OUR-RESIDENCE-HALLS/INDEX.SHTML



Residence Life

CHESAPEAKE HALL

FIFTH FLOOR

#DukesLiveClose
#DukesLiveSupported
#DukesLIVEON

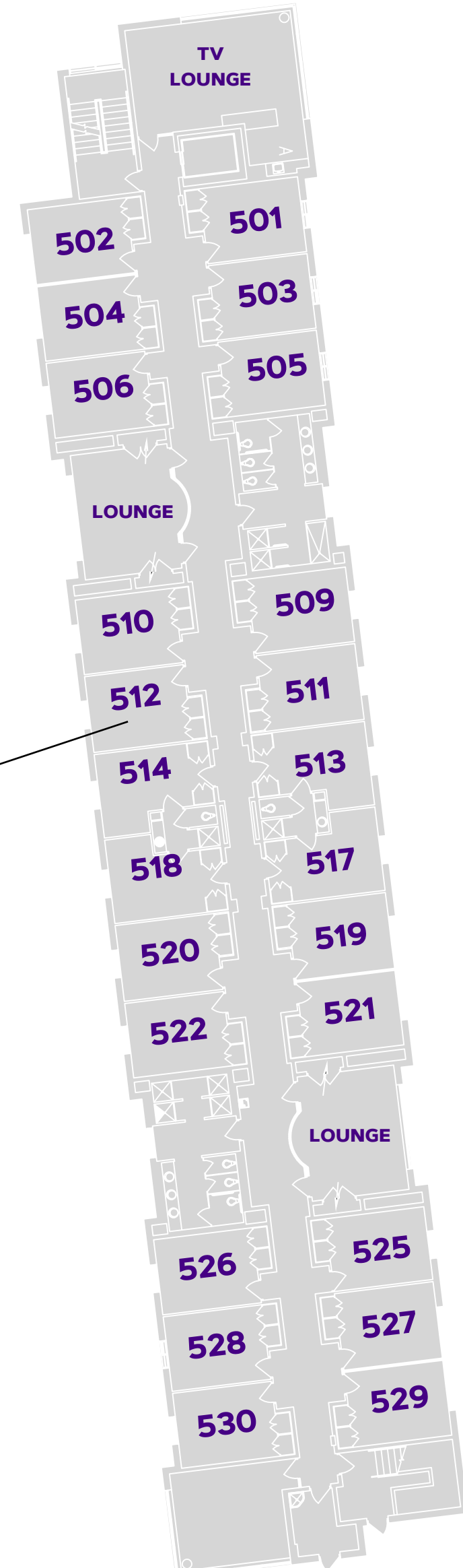

COURTYARD

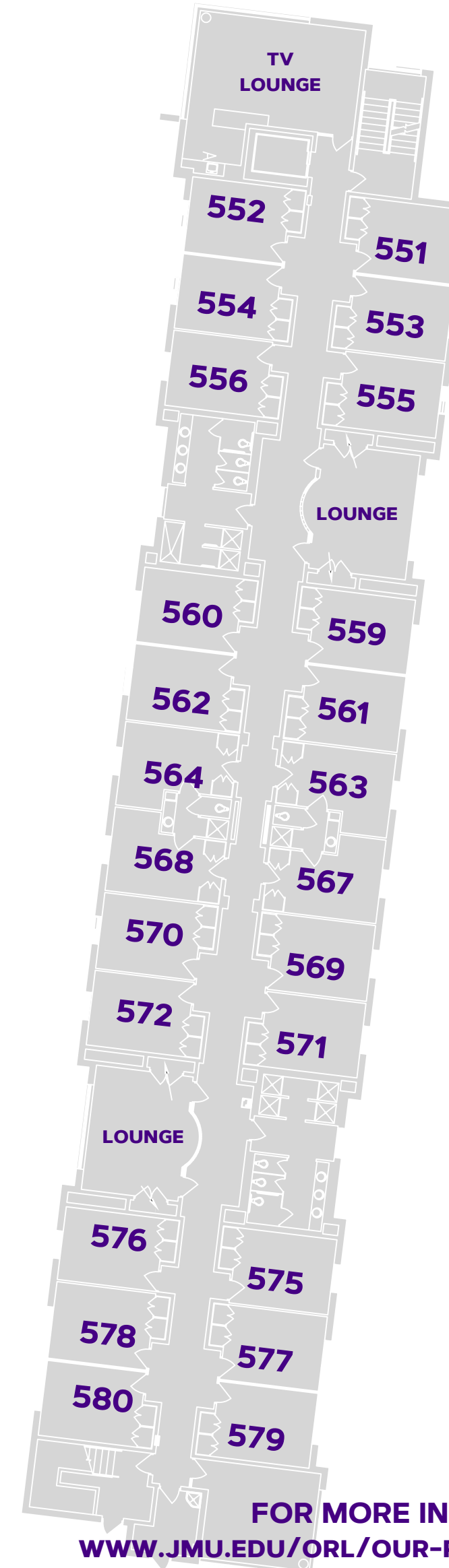

FACES
SHENANDOAH HALL

FACES
CHANDLER HALL

TYPICAL ROOM SPECS

ROOM SIZE: 11'7" X 12'
WINDOW SIZE: 4'4" X 4'8"
CEILING HEIGHT: 9'3"

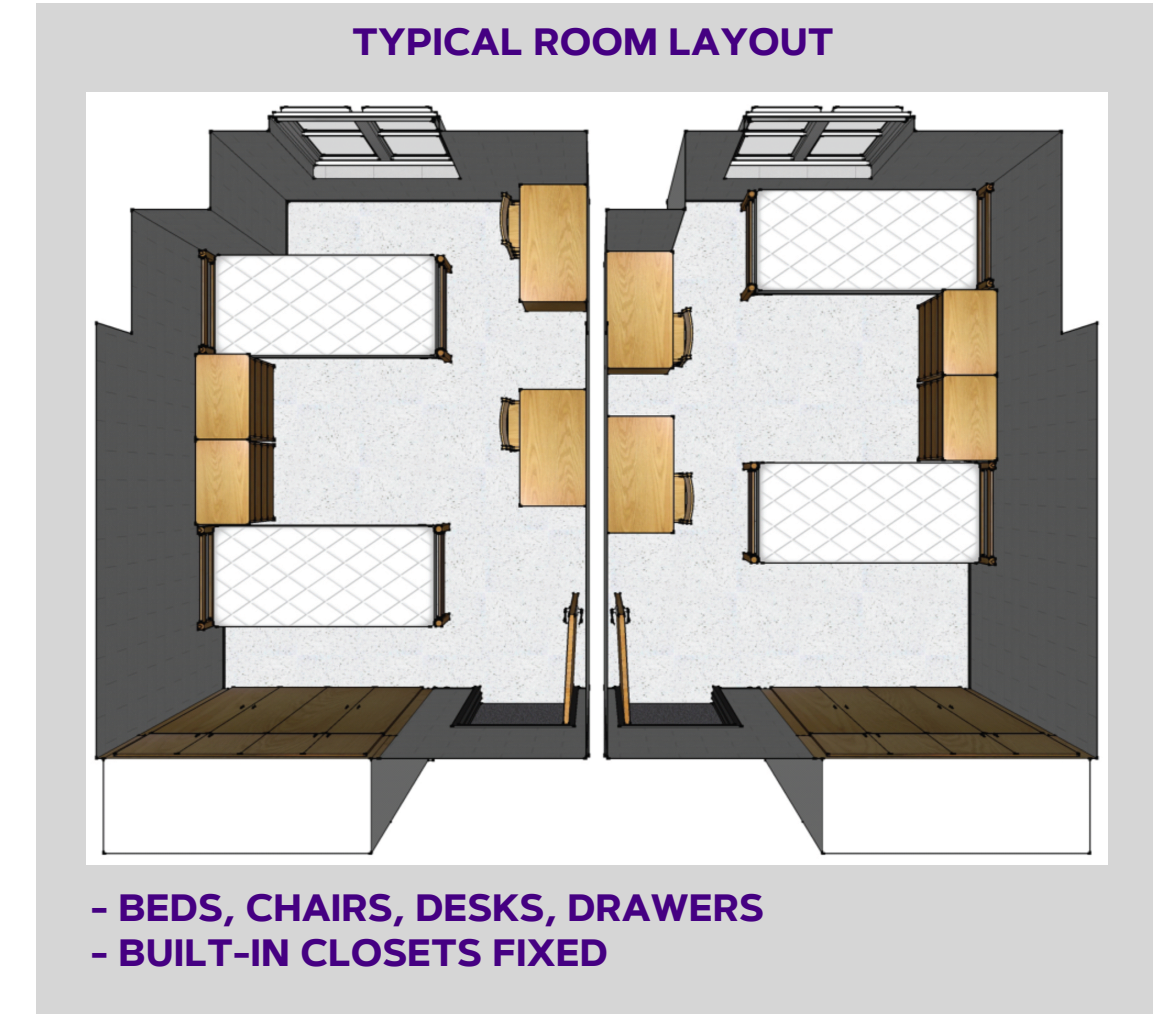

- BEDS, CHAIRS, DESKS, DRAWERS
- BUILT-IN CLOSETS FIXED

FOR MORE INFORMATION ON HALLS VISIT:
WWW.JMU.EDU/ORL/OUR-RESIDENCE-HALLS/INDEX.SHTML



Residence Life