

CHANDLER HALL

FIRST FLOOR

#DukesLiveClose
#DukesLiveSupported
#DukesLIVEON

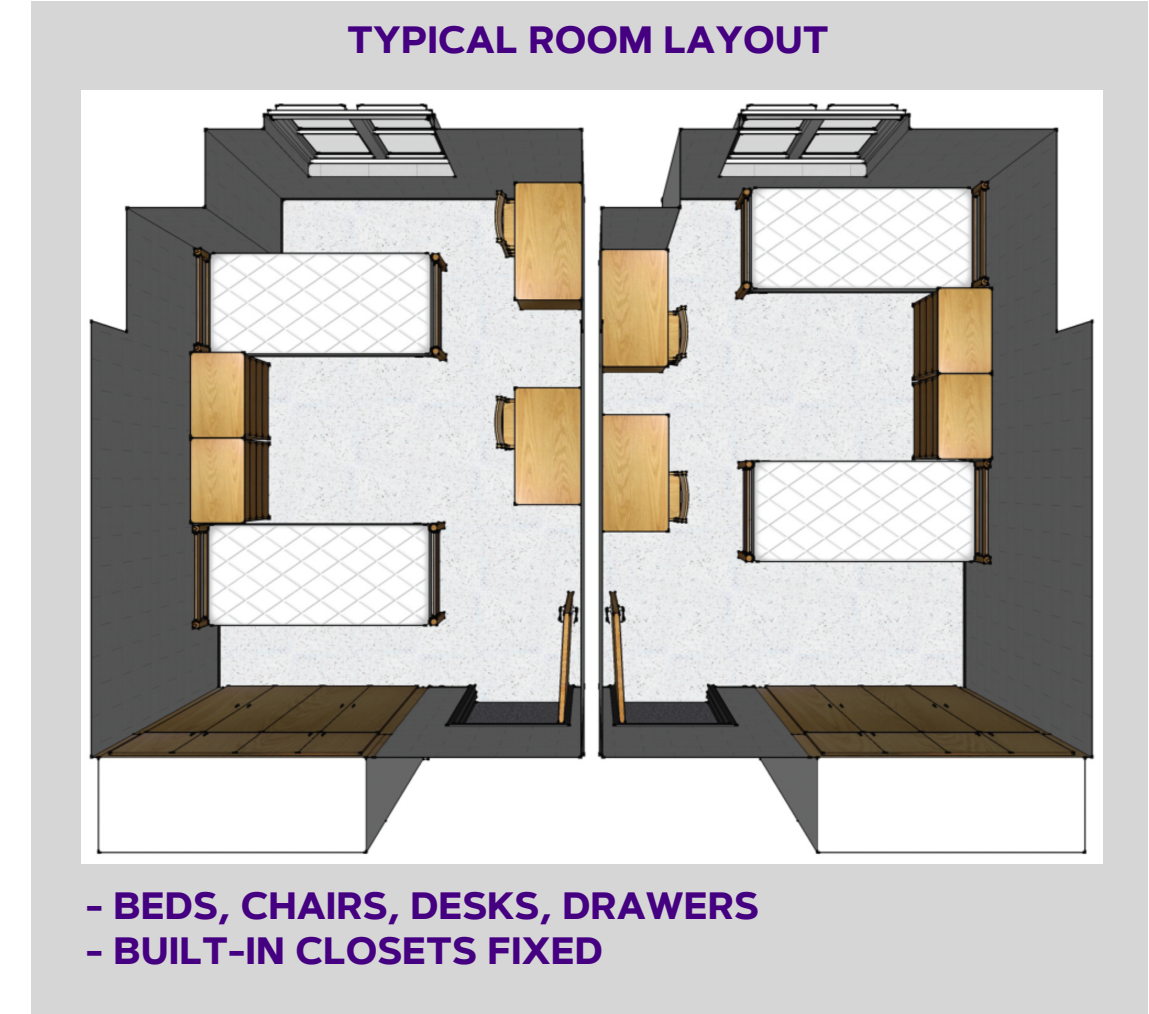
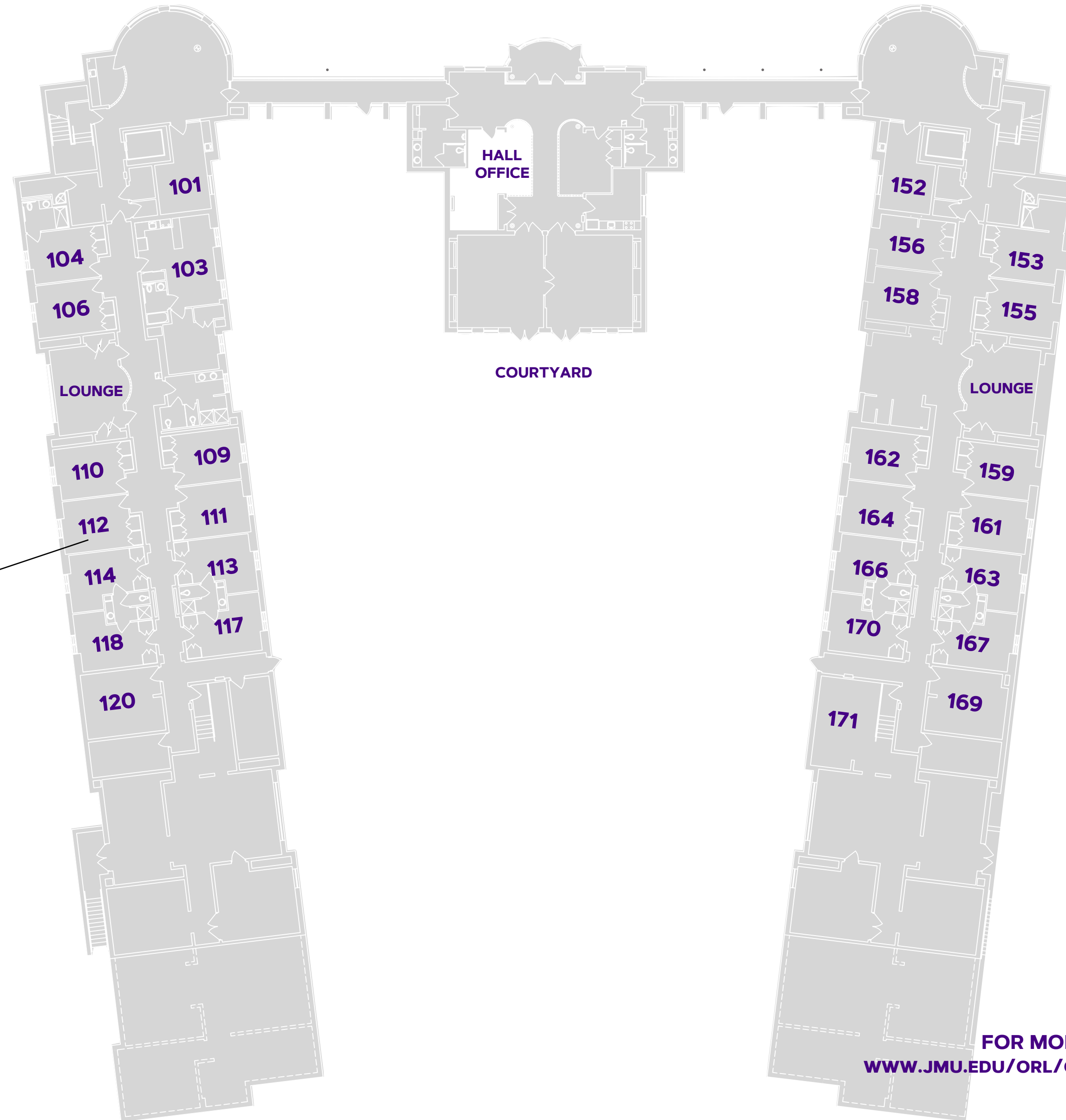

FACES
CHESAPEAKE HALL

FACES
CARRIER DRIVE

TYPICAL ROOM SPECS

ROOM SIZE: 11'7" x 12'
WINDOW SIZE: 4'4" x 4'8"
CEILING HEIGHT: 9'3"

FOR MORE INFORMATION ON HALLS VISIT:
WWW.JMU.EDU/ORL/OUR-RESIDENCE-HALLS/INDEX.SHTML

CHANDLER HALL

SECOND FLOOR

#DukesLiveClose
 #DukesLiveSupported
 #DukesLIVEON

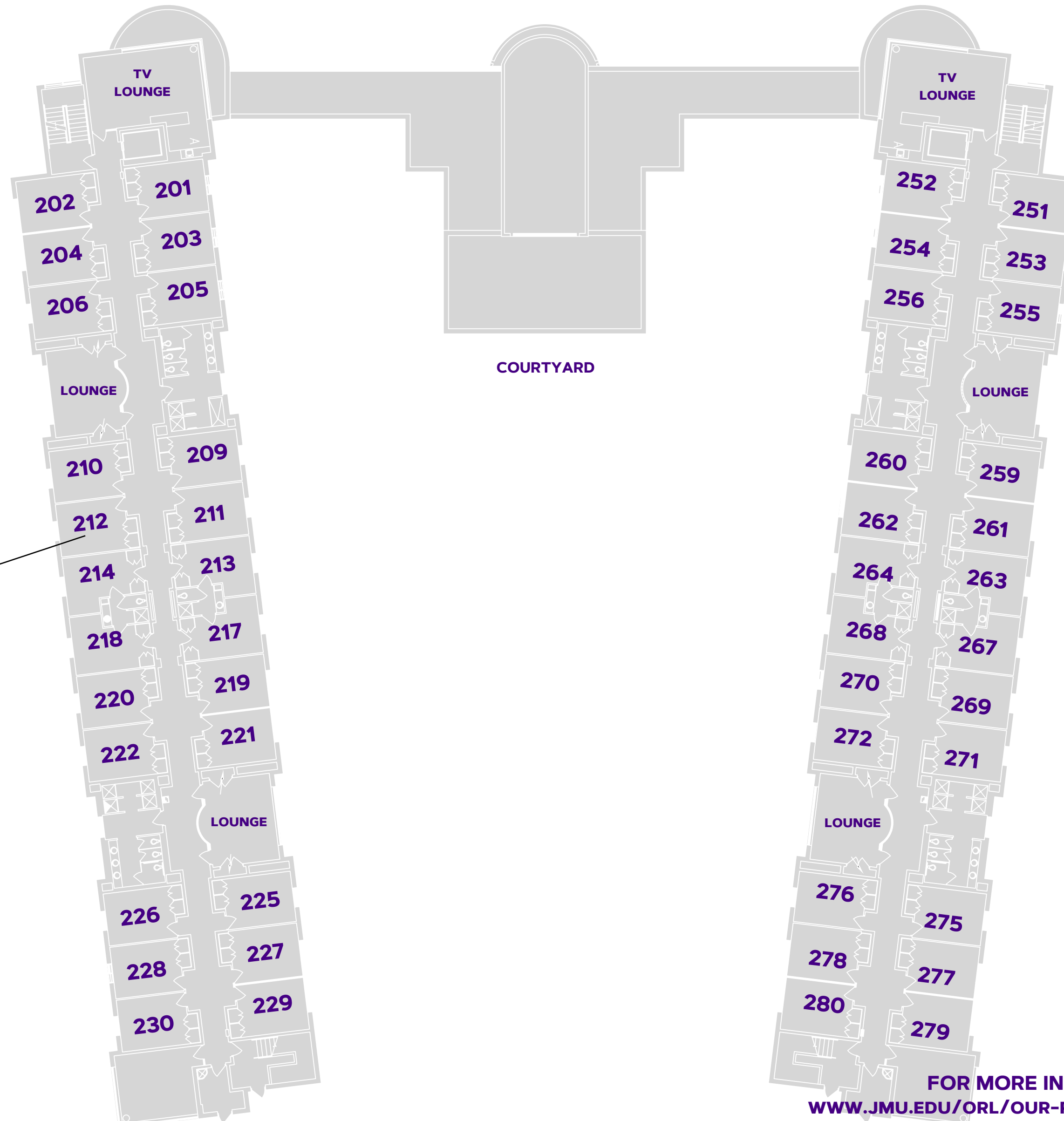

FACES
CHESAPEAKE HALL

FACES
CARRIER DRIVE

TYPICAL ROOM SPECS

ROOM SIZE: 11'7" X 12'
 WINDOW SIZE: 4'4" X 4'8"
 CEILING HEIGHT: 9'3"

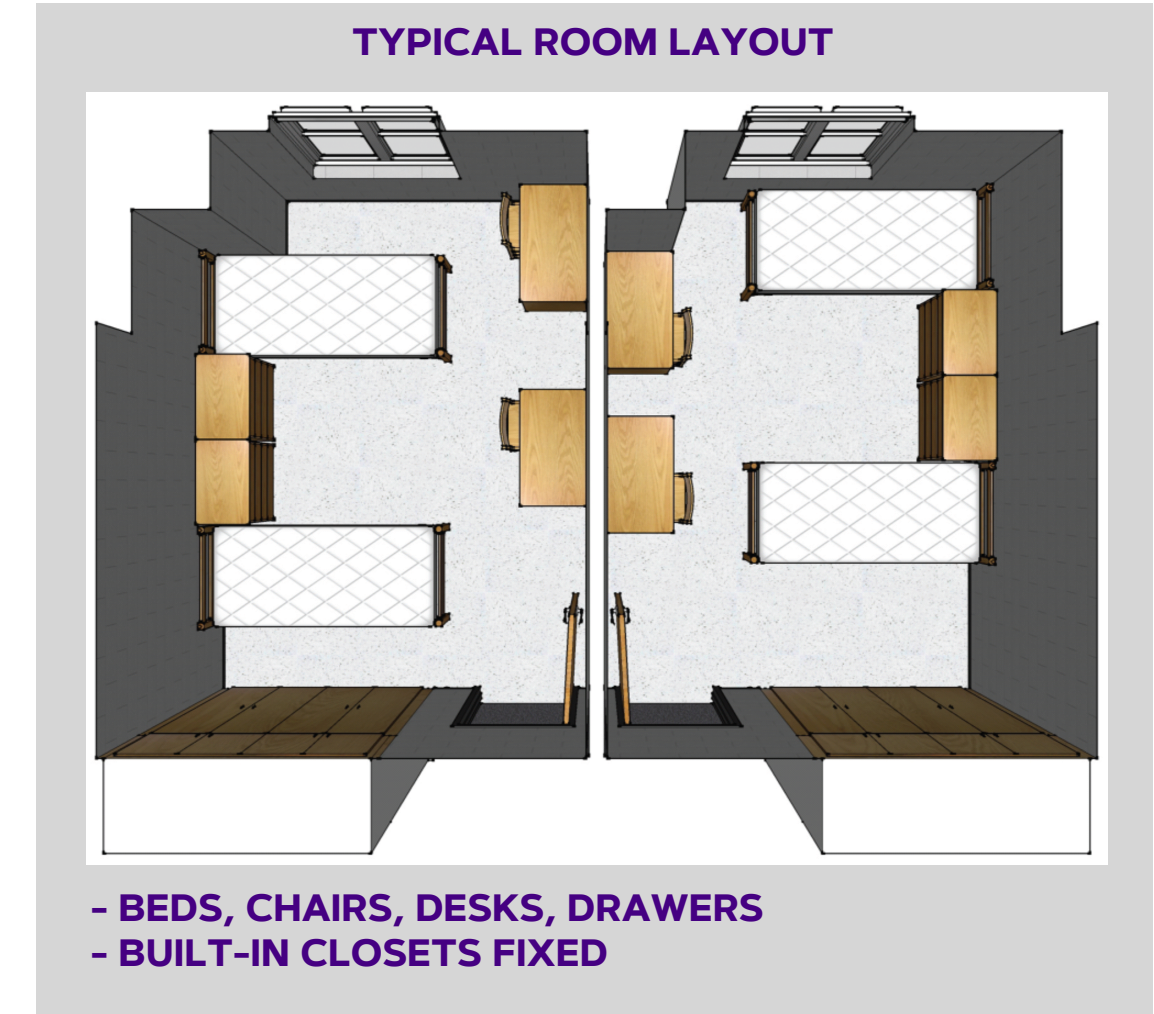

FOR MORE INFORMATION ON HALLS VISIT:
WWW.JMU.EDU/ORL/OUR-RESIDENCE-HALLS/INDEX.SHTML

CHANDLER HALL

THIRD FLOOR

#DukesLiveClose
 #DukesLiveSupported
 #DukesLIVEON

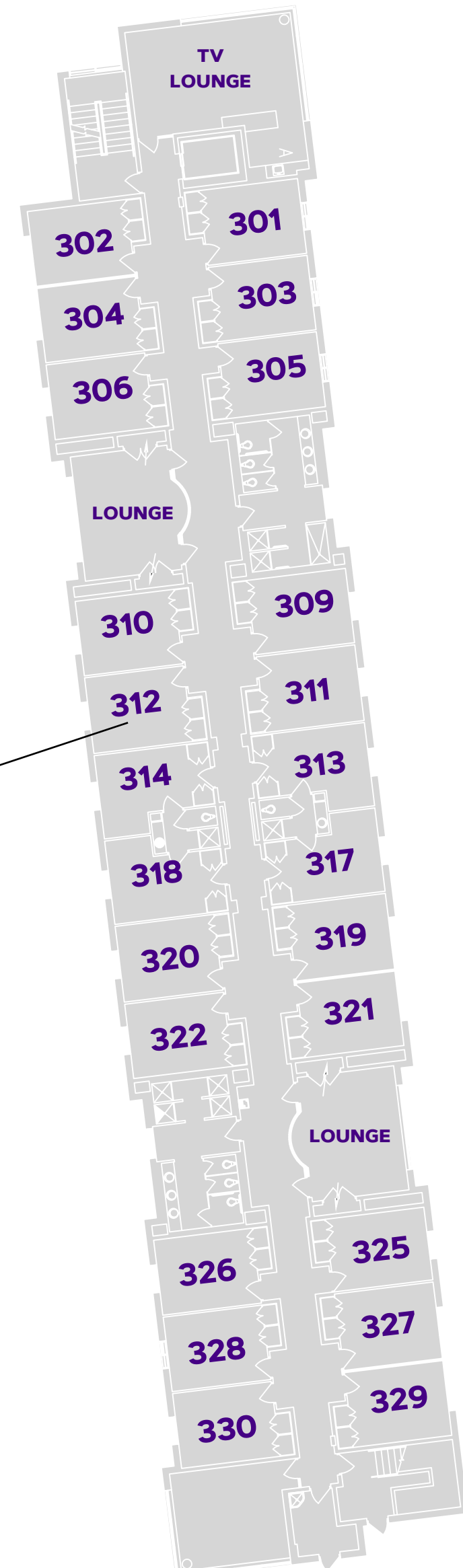

COURTYARD

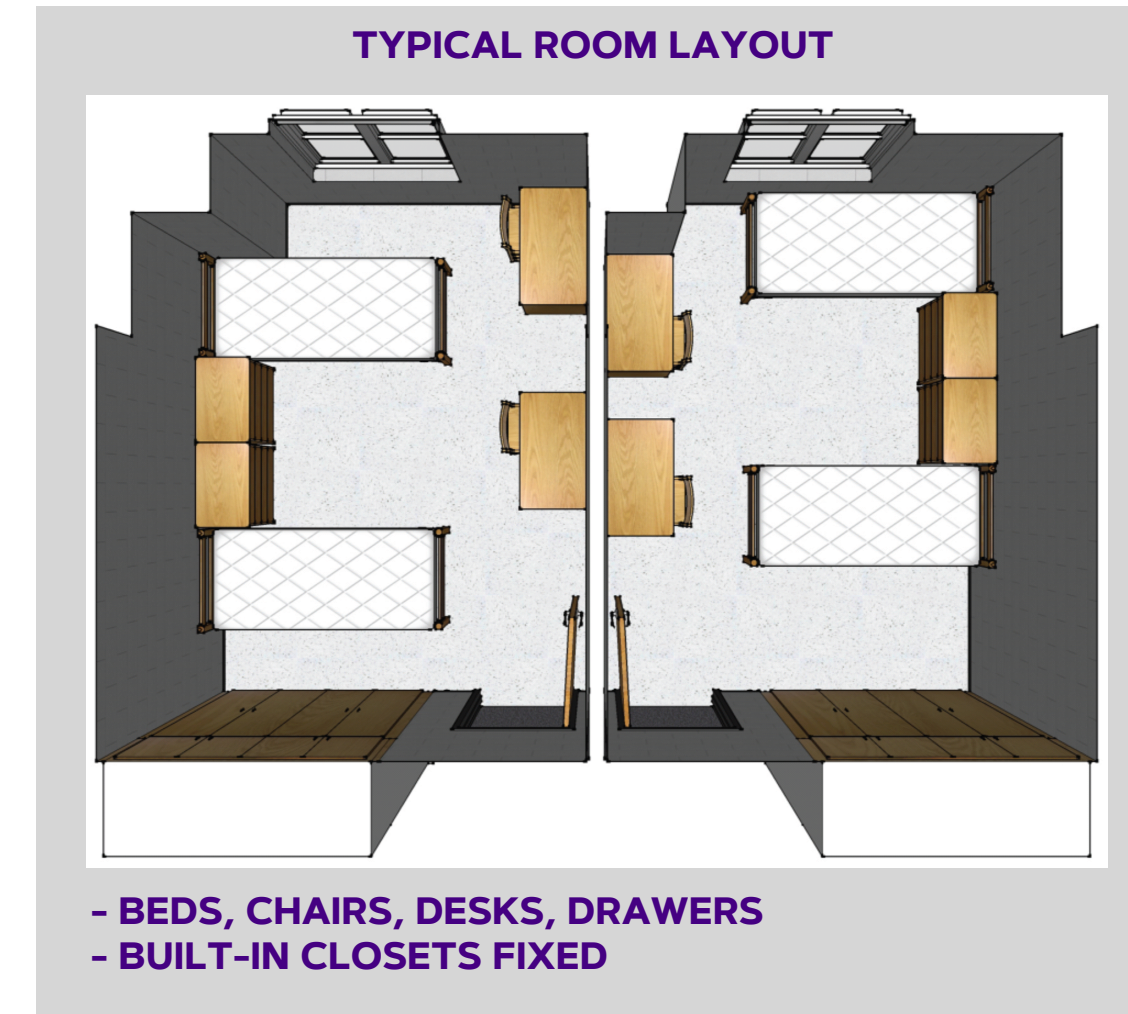
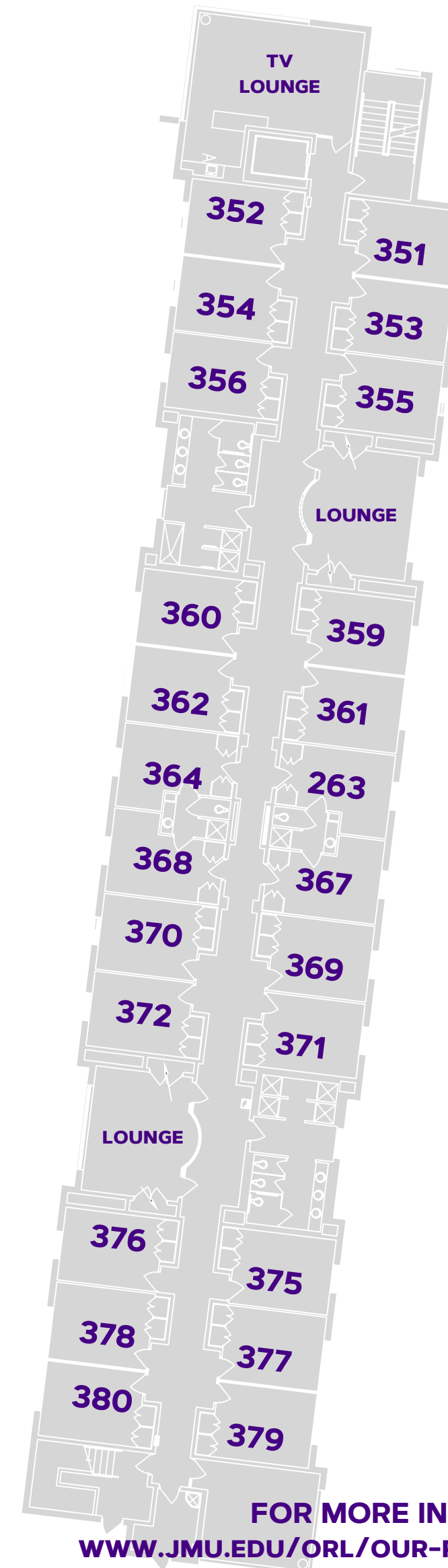

FACES
CHESAPEAKE HALL

FACES
CARRIER DRIVE

TYPICAL ROOM SPECS

ROOM SIZE: 11'7" X 12'
 WINDOW SIZE: 4'4" X 4'8"
 CEILING HEIGHT: 9'3"

FOR MORE INFORMATION ON HALLS VISIT:
WWW.JMU.EDU/ORL/OUR-RESIDENCE-HALLS/INDEX.SHTML

CHANDLER HALL

FOURTH FLOOR

#DukesLiveClose
 #DukesLiveSupported
 #DukesLIVEON

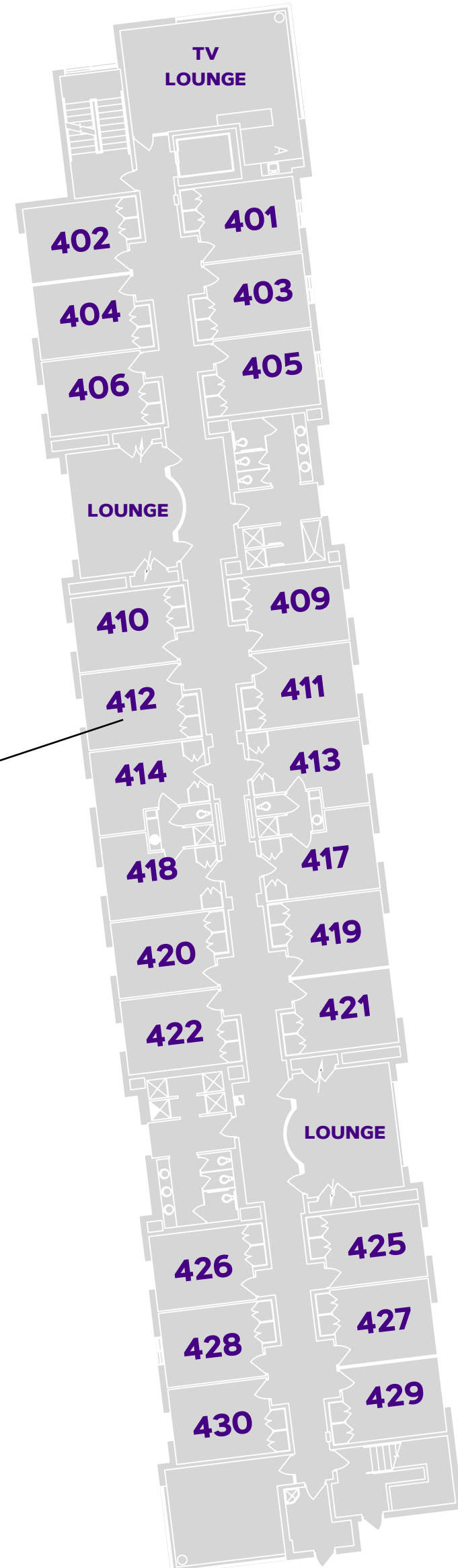

COURTYARD

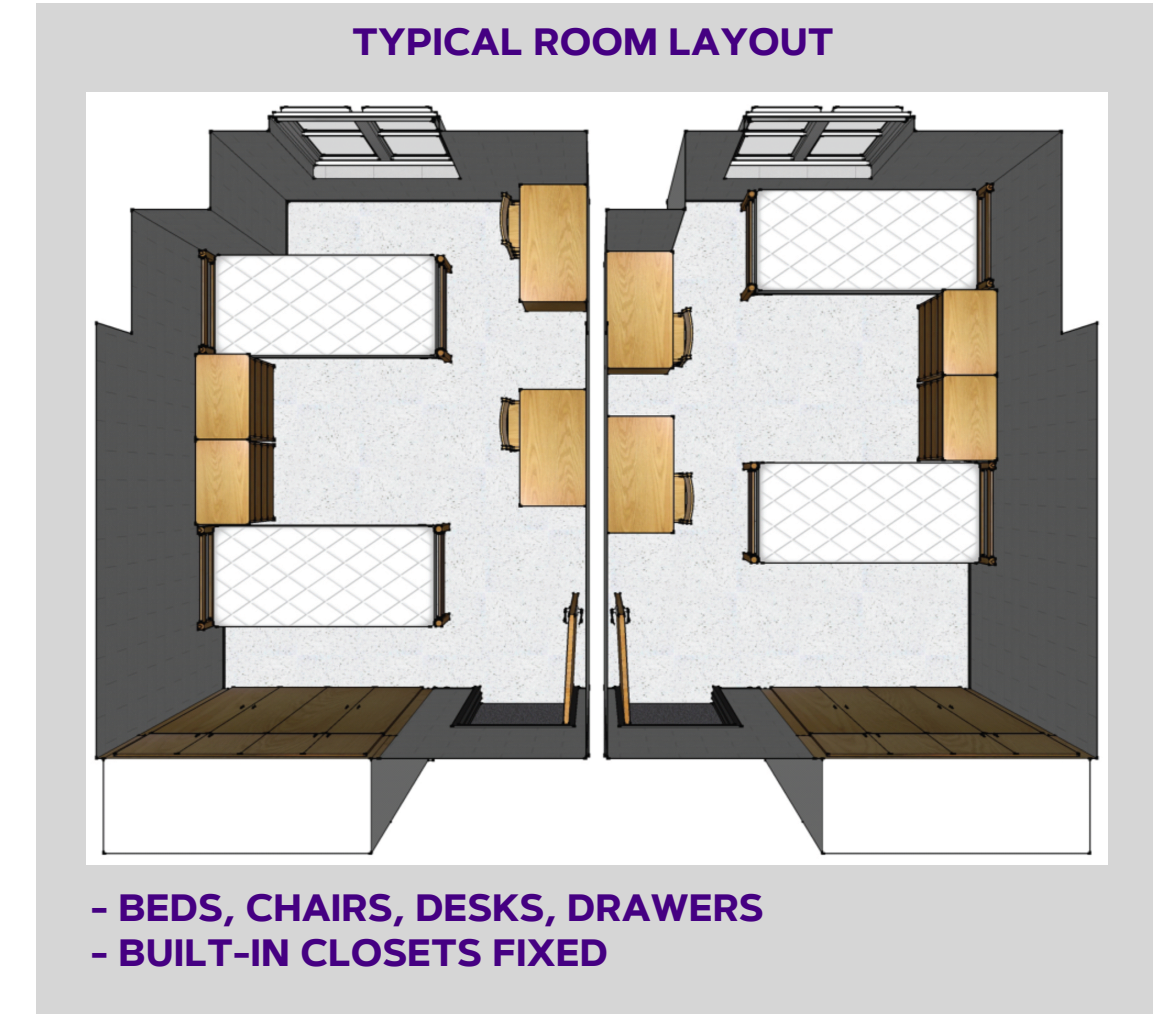
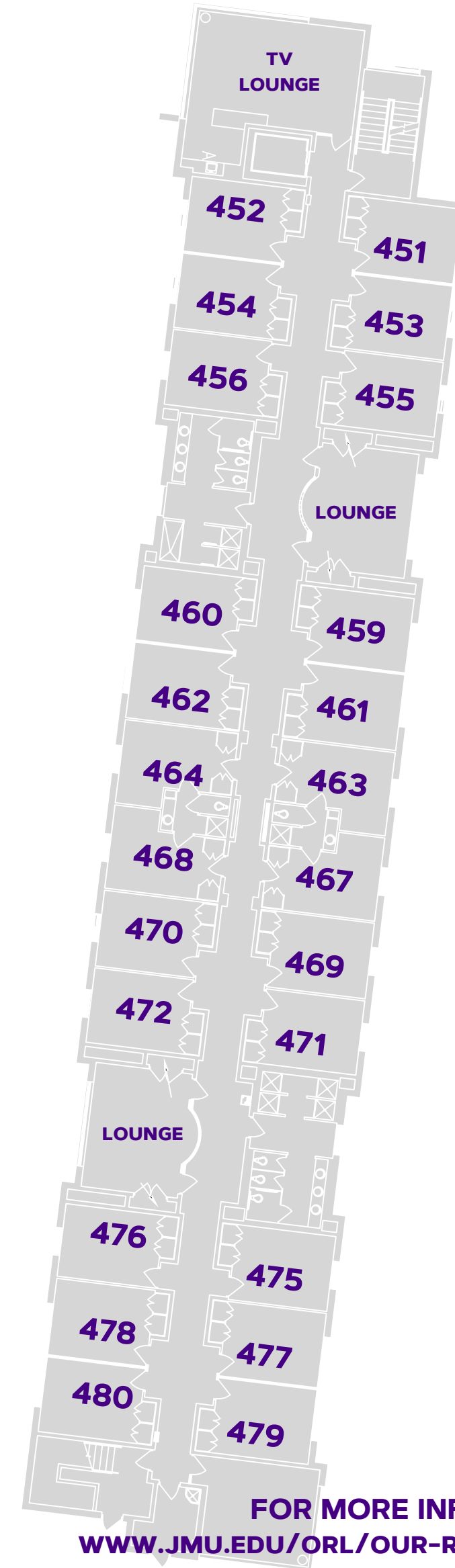

FACES
CHESAPEAKE HALL

FACES
CARRIER DRIVE

TYPICAL ROOM SPECS
 ROOM SIZE: 11'7" X 12'
 WINDOW SIZE: 4'4" X 4'8"
 CEILING HEIGHT: 9'3"

FOR MORE INFORMATION ON HALLS VISIT:
WWW.JMU.EDU/ORL/OUR-RESIDENCE-HALLS/INDEX.SHTML



CHANDLER HALL

FIFTH FLOOR

#DukesLiveClose
#DukesLiveSupported
#DukesLIVEON

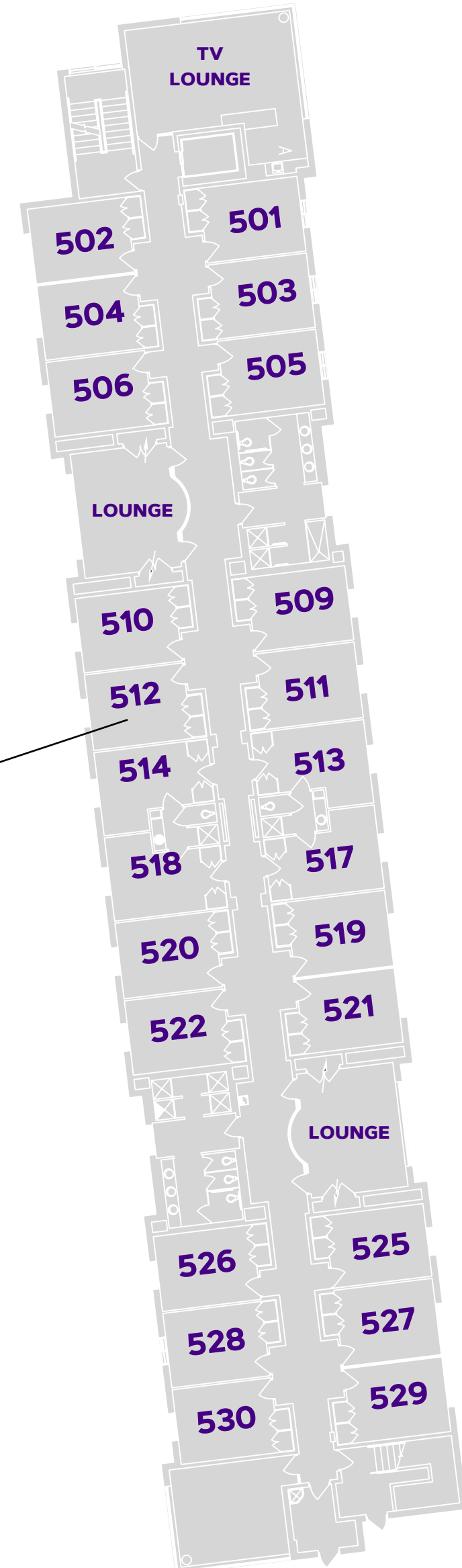

COURTYARD

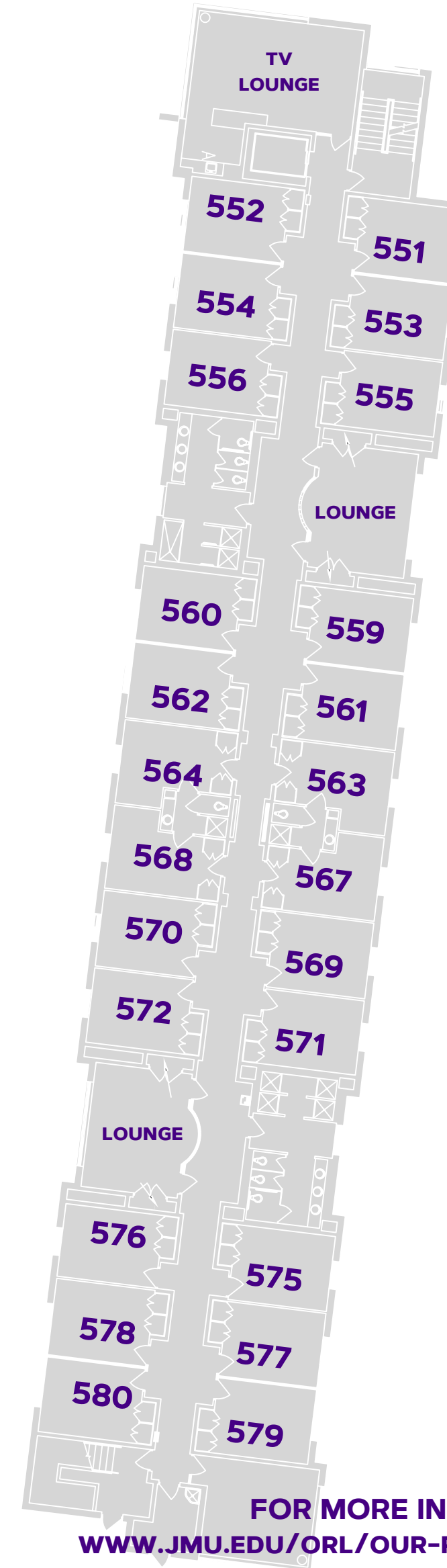

FACES
CHESAPEAKE HALL

FACES
CARRIER DRIVE

TYPICAL ROOM SPECS

ROOM SIZE: 11'7" X 12'
WINDOW SIZE: 4'4" X 4'8"
CEILING HEIGHT: 9'3"

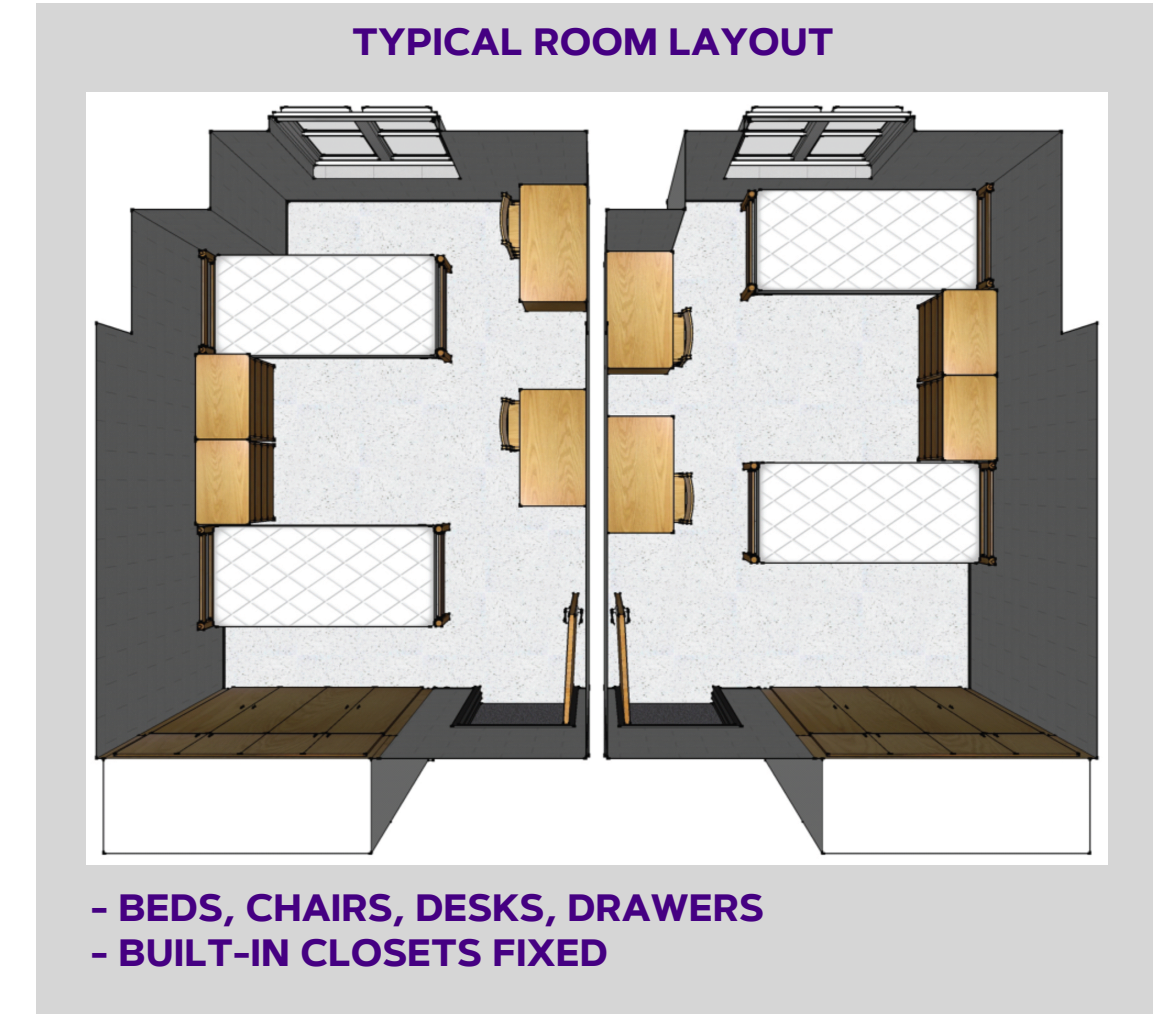

FOR MORE INFORMATION ON HALLS VISIT:
WWW.JMU.EDU/ORL/OUR-RESIDENCE-HALLS/INDEX.SHTML



Residence Life